

PRODUCT DATA SHEET

9203-ASL Sensor

4-20mA coated wideband sensor, 9203-ASL

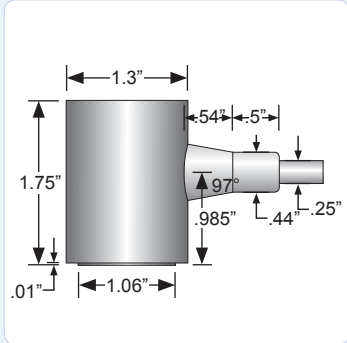

DESCRIPTION AND FEATURES

The 9203-ASL smart sensor has unsurpassed sensitivities, high signal to noise ratio, high EMI immunity and predictable frequency response. The ASL version of the RXX sensors and the 9203 sensor contain an integral preamp, a programmable gain amplifier, a precision RMS signal conditioner, a 4-20 mA current transmitter, a HART modem and a mixed signal RISC microcontroller for AE signal processing. Within this series of sensors there are a variety of models available, each with different frequency response ranges.

The sensor response can be monitored either by connecting a power source to the loop return and through a termination resistor (typically 250 ohms) and measuring the voltage drop across the resistor or through communication with the HART modem. The sensor is also fully configurable via the Hart interface using an Emerson 475 Field Communicator or a USB-to-HART modem.

APPLICATIONS

The sensor can be used for general purpose Structural Health Monitoring, Leak Monitoring, Flow Monitoring, Machine Wear and Machine Protection Systems.

* Characterization curve for sensing element only (no preamp)

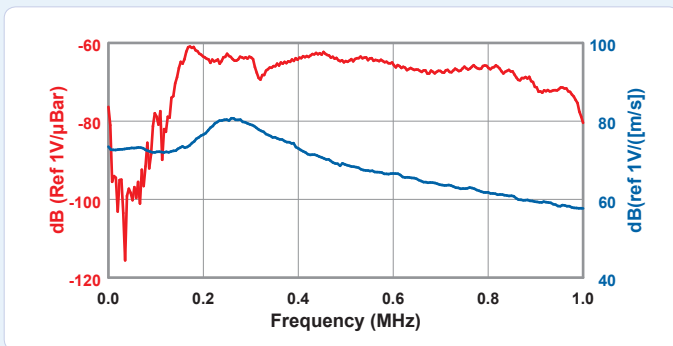

OPERATING SPECIFICATIONS

Dynamic

Peak Sensitivity, Ref 1V/μbar -62 dB
 Operating Frequency Range 100-600 kHz
 Directionality +/-1.5 dB

Environmental

Temperature Range -40 to 70° C

Physical

Dimensions* 1.3"OD X 1.75"H
 33.0 mm OD X 44.4 mm H
 Weight (g) 110
 Case Material Epoxy over Stainless Steel
 Face Material Ceramic
 Connector Flying Leads/Pigtail
 Cable Shielded, twisted pair, 24 AWG
 Connector Locations Side

Electrical

Gain Auto Gain
 Preamp DC power (V) 12 - 30 volts DC, 4-20mA
 Grounding Case Isolated
 + Isolated Mounting Surface
 Noise <16 dBAE
 4-20 mA Output Drive Corresponds to 0-100 dB
 (1-5 volts using a 250 ohm load resistor)

ORDERING INFORMATION AND ACCESSORIES

9203-ASL 9203-ASL
 Magnetic Hold-Down MHR15IUC
 Cable Length (specify in 'm') 2m Default

Sensors include

Characterization Certificate & Warranty

* Due to variances in coating process, the height of coated sensors may vary within a tolerance of +/- 0.015 inches (.381 mm)

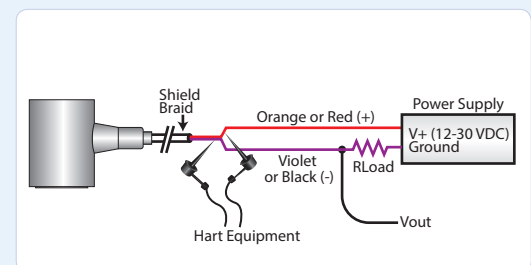

WORLDWIDE HEADQUARTERS:
 195 Clarksville Rd •
 Princeton Jct, NJ 08550 • USA
 T: +1.609.716.4000 • F: +1.609.716.0706
 E-MAIL: sales.systems@mistrasgroup.com
 WEB: www.mistrasgroup.com

CANADA T: +1.403.556.1350
CHINA T: +86.10.5877.3672
FRANCE T: +331.498.26040
GERMANY T: +49.040.2000.4025
GREECE T: +30.210.2846.801
HOLLAND T: +31.010.245.0325

INDIA T: +91.22.2586.2444
MIDDLE EAST T: +44(0)1954.231.612
SCANDINAVIA T: +46(0)31.252040
S. AMERICA T: +55.11.3082.5111
UK T: +44(0)1954.231.612

